



# Dual Temperature Wine Dispenser

Pro-Line Wine 59" - 8 Keg

- Designed by wine-industry experts for performance and value.
- Two dedicated temperature zones for optimal wine dispensing.
- Pre-drilled for customer tower choice.
- Commercial grade construction – built to last.



Black  
**MDD58W**



► **Shown:** 2 Wine Fonts MTM-4PSS-W, 2 Drip Trays DP-1020.  
Order separately.



► **Dual Temperature:** Built In Digital Thermostats.

## Feature



Listed by Edison  
Testing Laboratories.  
Conforms to UL & NSF Standards.



Wine Certified.

[www.micromatic.com](http://www.micromatic.com)

1 (866) 327-4159

Job Number: \_\_\_\_\_ Location: \_\_\_\_\_

# Specifications

Micro Matic reserves the right to change specifications without notice. **AUTOQUOTES**

Part No.	Exterior Finish	Doors	Shipping Weight	Box Dimensions
☐ <b>MDD58W</b>	Black	2	143 kg	1537mm L x 762mm W x 1270mm H
			315 lbs	60 1/2"L x 30"W x 50"H

# Operating Performance

<b>Capacity of 20 Liter Kegs</b>	8 (4 per zone)	<b>Running Amps</b>	6.5
<b>Cubic Feet Per Side</b>	TBD	<b>Condenser HP</b>	1/3
<b>Holes for Wine Fonts</b>	2	<b>Voltage</b>	115/60/1
<b>Hole Diameter</b>	3"	<b>Plug Type</b>	NEMA-5-15P
<b>Color-coded Digital Thermostats</b>	2 (Blue LED-Whites & Red LED-Reds)	<b>Cord Length</b>	8'
<b>Temperature Range - Whites</b>	42-48°F (5.5-8.8C)	<b>Refrigerant</b>	R-134a
<b>Temperature Range - Reds</b>	55-65°F (12.7-18.3C)	<b>Charge oz (Grs)</b>	10.5 (300)
<b>Approval</b>	ETL Listed		

<b>Exterior</b>	18 gauge stainless steel top, 22 gauge solid self-closing doors, black vinyl over 24 gauge steel front, sides and back.
<b>Interior</b>	20 gauge stainless steel floor, rugged false floor, reinforced frame, 24 gauge galvanized walls.
<b>Ventilation</b>	Front and side ventilated
<b>Plumbing</b>	Automatic condensate evaporator, no drain connection required. Evaporator condensate has been plumbed to a condensate pan located in the compressor housing.
<b>Insulation</b>	Foamed-in-place using high density, CFC-free polyurethane; 1-1/2" top, walls and floor.
<b>Accessories</b>	Castors or 6" Fixed Legs

# Dimensions

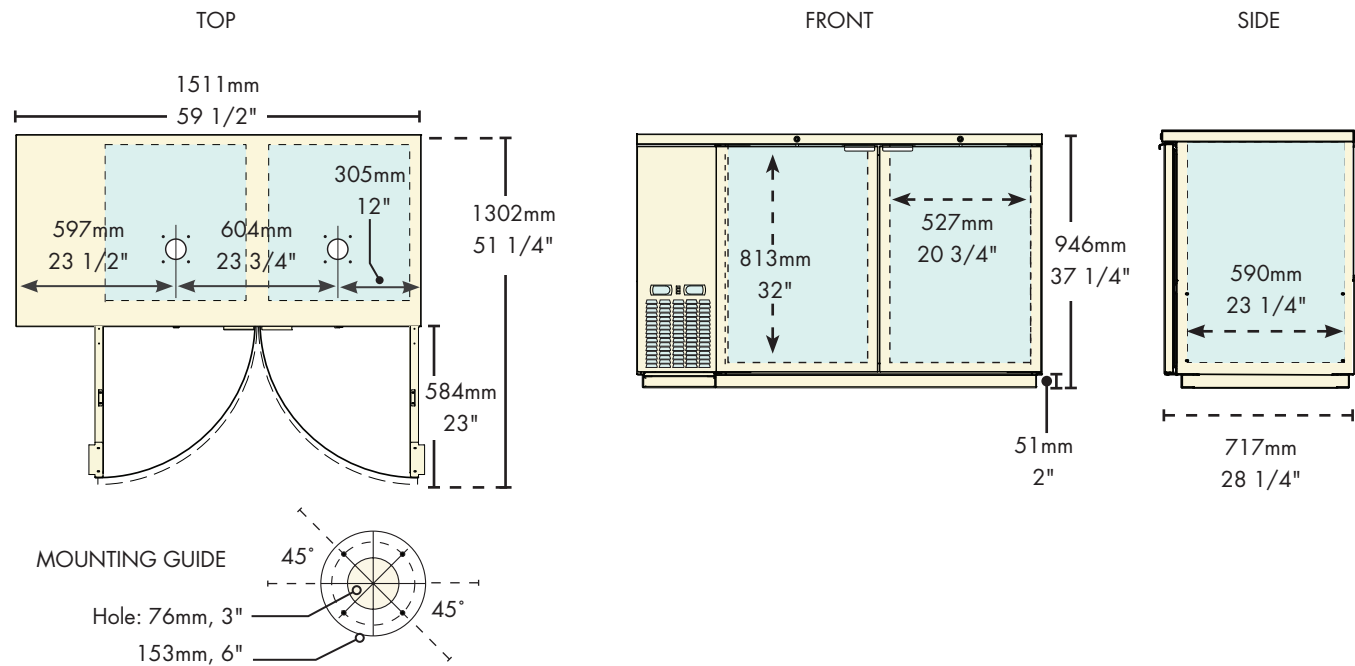

Copyright ©2012 Micro Matic USA, Inc. All Rights Reserved.

01125D0412



[www.micromatic.com](http://www.micromatic.com)

Toll Free: 1-(866) 327-4159

West	Central	Southeast	Northeast
19791 Bahama Street Northridge, CA 91324 Tel. (818) 701-9765 Fax. (818) 701-9844	10726 North Second Street Machesney Park, IL 61115 Tel. (815) 968-7557 Fax. (815) 968-0363	2364 Simon Court Brooksville, FL 34604 Tel. (352) 799-6331 Fax. (352) 796-2429	4601 Saucon Creek Road Center Valley, PA 18034 Tel. (610) 625-4464 Fax. (610) 625-4466