



Deep Well Horizontal Bottle Cooler

Pro-Line 95" - 43 Case

- Designed by beer-industry experts for performance and value.
- Commercial grade construction – built to last.
- Raised glass rail on top creates convenient storage area.
- Free flow refrigeration system ensures “Ice Cold” products.



Black
MDW95



Stainless Steel
MDW95S

Feature



Listed by Edison
Testing Laboratories.
Conforms to UL & NSF Standards.

www.micromatic.com

1 (866) 327-4159

Job Number: _____ Location: _____

Specifications

Micro Matic reserves the right to change specifications without notice. **AUTOQUOTES**

Part No.	Exterior Finish	Lids	Shipping Weight	Box Dimensions
☐ MDW95	Black	3	231 kg	2413mm L x 712mm W x 839mm H
			508 lbs	95 3/8"L x 28"W x 33 3/8"H
☐ MDW95S	Stainless Steel	3	231 kg	2413mm L x 712mm W x 839mm H
			508 lbs	95 3/8"L x 28"W x 33 3/8"H

Operating Performance

Capacity	58.7 cases (12 oz can)	Condenser HP	1/2
	43.2 cases (12 oz bottle)	Running Amps	6.5
Dividers	7	Voltage	115/60/1
Lid Locks	Standard	Plug Type	NEMA-5-15R
Interior Light	Standard	Cord Length	8'
Cap Opener/Catcher	Standard	Refrigerant	R-134a

Exterior	All Models: 18 gauge stainless steel top with raised glass rails. Black Models: Front, sides, and back black vinyl over steel. Stainless Steel Models: Front, sides and back are stainless steel.
Interior	Durable galvanized steel. NSF approved for pre-packaged and bottle products.
Ventilation	Front and side ventilation.
Plumbing	Automatic condensate evaporator, no drain connection required. Evaporator condensate has been plumbed to a condensate pan located in the compressor housing.
Insulation	Foamed-in-place using high density, CFC-free polyurethane; 1-1/2" top, walls and floor.
Accessories	Castors or 6" Fixed Legs

Dimensions

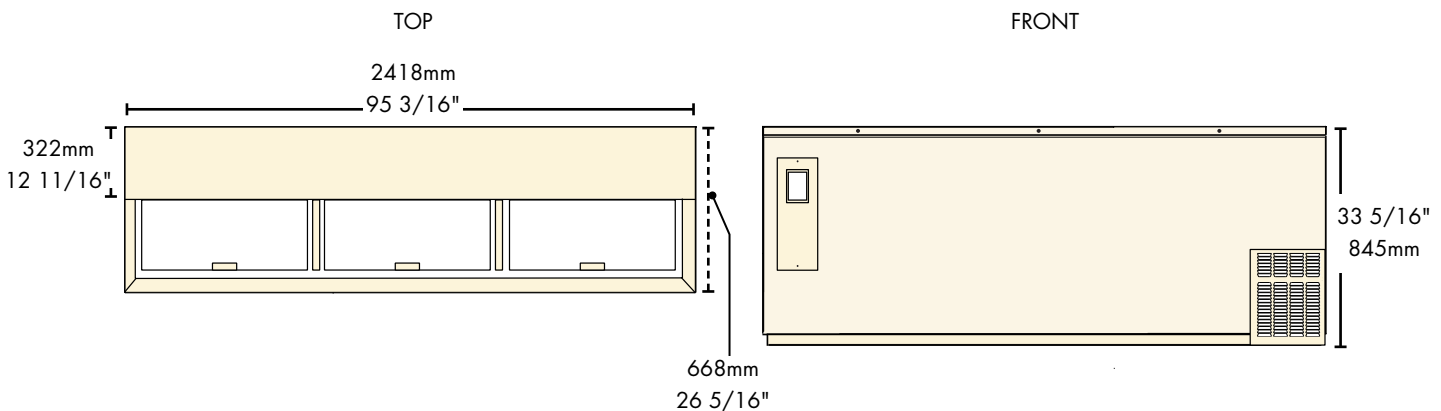

Copyright ©2012 Micro Matic USA, Inc. All Rights Reserved. 00839-D0312



www.micromatic.com

Toll Free: 1-(866) 327-4159

West	Central	Southeast	Northeast
19791 Bahama Street Northridge, CA 91324 Tel. (818) 701-9765 Fax. (818) 701-9844	10726 North Second Street Machesney Park, IL 61115 Tel. (815) 968-7557 Fax. (815) 968-0363	2364 Simon Court Brooksville, FL 34604 Tel. (352) 799-6331 Fax. (352) 796-2429	4601 Saucon Creek Road Center Valley, PA 18034 Tel. (610) 625-4464 Fax. (610) 625-4466