

RSV Dispense Coupler - Instructions

CONNECT



1
Insert Coupler



2
Turn Handle
Clockwise



3
Push Down Handle



4
Handle Clicks, Locks
& Remains Down

DISCONNECT

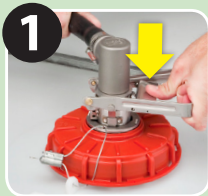

1
Push Down Handle
Button with Thumb



2
Handle Unlocks &
Releases up



3
Turn Handle
Counter-Clockwise



4
Pull up to Remove